

Filename: H:\2607_Proposed\Drawings\CAD\Sheet\2607-KPF-MPLN-RF-DR-PLN-A-0150.dwg Plotted By: Aesopig, Bear Plot Time: 9/12/2019 12:20 PM

Bermondsey Project

Client
Southwark GP Nominee 1 Ltd. and
Southwark GP Nominee 2 Ltd.

KPF
Kohn Pedersen Fox Associates
(International) PA
Architects and Planning Consultants

7a Langley Street, London WC2H 9JA
T: +44 (0) 20 3119 5300
http://www.kpf.com

Structural Engineer
WSP - Tel: 207 337 1700
MEP Engineer
Hilson Moran - Tel: 207 940 8888
Landscape Consultant (Strategy)
Arup - Tel: 207 636 1531
Landscape Consultant (Design)
Andy Sturgeon - Tel: 127 367 2575
Structural Engineer (Building F)
AKT II - Tel: 207 250 7777

Key Plan

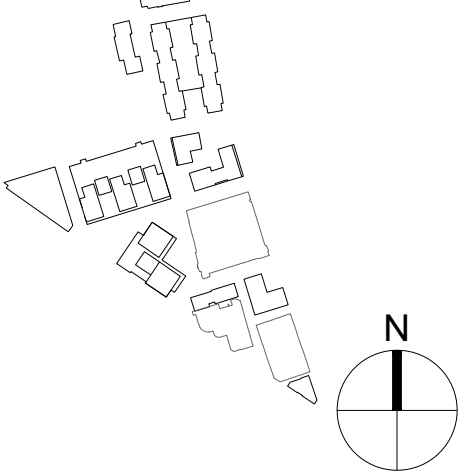

Notes

- THE DETAILED DESIGN OF THE HARD AND SOFT LANDSCAPE IS SHOWN FOR ILLUSTRATIVE PURPOSES ONLY.
 - THE DETAILED DESIGN OF THE RESIDENT'S COMMUNAL GARDENS / TERRACES ARE SHOWN FOR ILLUSTRATIVE PURPOSES ONLY.
- OUTLINE COMPONENT
PRIVATE TERRACE / BALCONY
- 0 12.5M 25M 50M
SCALE: 1:500

C	AMENDED PROPOSALS	16.09.19
B	ADDENDUM	04.06.18
A	ADDENDUM	10.01.18
No.	DESCRIPTION	DATE

KPF

Project
2607 Bermondsey Project
Scale
1:500 @ A0
Drawing Title and No.
SITE ROOF PLAN
PROPOSED
Drawing Ref.
2607-KPF-MPLN-RF-DR-PLN-
A-0150
Rev.
C

© 2017 KOHN PEDERSEN FOX ASSOCIATES (INTERNATIONAL) PA. All rights reserved.
Where shown, copyright Ordnance Survey data © Crown Copyright. License No. 10029184